

Performer P16, P16s

In this documentation you will find information about:

- Description
- Placement
- Maintenance
- Connections
- Flying system
- Options
- Dynamic Damping Control
- Technical specifications

Description

The P16(s) inhabits two 15" SA1513 direct radiating woofers. Designed as part of a (ground stacking) system. One or two P26 will stack firmly on top of these subs. Compact light-weight design.

Placement

The P16(s) can be placed directly on the floor or stacked. With the Uni-Rig™ flying hardware the P16s can also be flown. Please note that bass-response may vary with the position of the cabinet, through "acoustic coupling"! (floor, ceiling and wall reflections).

Maintenance

Maintenance on the P16(s), especially on the drivers, is best left to official Stage Accompany service personnel. However, cleaning of the cabinet can easily be done by yourself with a damp lint-free cloth

Connections

The P16(s) has an 8-pole SpeakON connector and should be connected to the connector panel of the appropriate power rack which comes with the Performer system. Because the P16(s) is a low frequency cabinet it must be connected to the 'low' output of the connector panel (see illustration below).

Flying system

The P16s standard equipped with the Uni-Rig™ flying system. The accompanying "fly-ware" can be ordered at your local dealer.

Options

The P16 and P16s are standard finished in SA Black Protecture, but is also available in any possible RAL color (Multi Color Option).

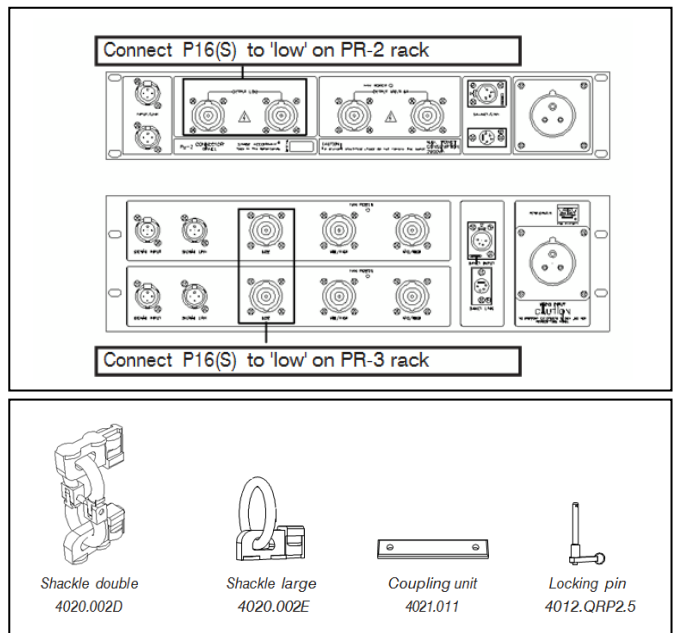
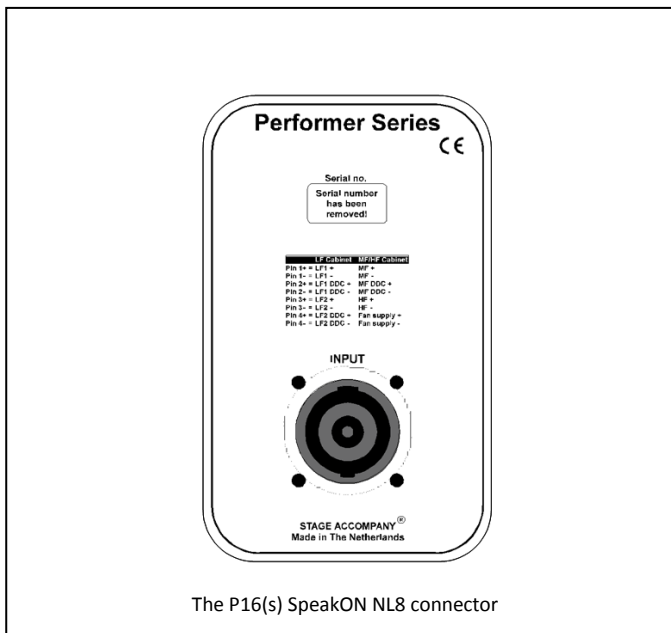

Wiring for DDC™

For absolute top quality sound reproduction, the P16(s) is equipped with Dynamic Damping Control™. The DDC™ system is based on two loudspeaker wires that return from the speaker to the (SA) amplifier. The picture on the right shows the wiring of SpeakON NL8 connector in combination with the DDC™ system.

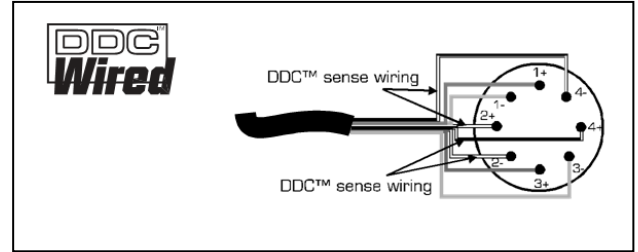

Technical specifications

Frequency response	:	40Hz – 100Hz (+/- 3dB)
Transducers	:	2 x SA1513, 15" LF driver
Recommended cross-over frequency	:	100Hz
Nominal impedance	:	4Ω
Sensitivity @ 1W/1m	:	99dB
Max. RMS power	:	800W
Max. Peak power	:	2000W
SPL program/peak	:	128dB/132dB
Signal processing	:	presets for various controllers are available on request
Enclosure construction	:	15mm Birch plywood, 6 handles (P16s only), Protecture finish
Rigging	:	integrated flying hardware (P16s only)
Color	:	SA Black, other colors on request
Front	:	expanded steel with acoustic transparent cloth
Connectors	:	1 x SpeakOn NL8
Physical dimensions (H x W x D)	:	P16, 730mm x 730mm x 600mm (28.7" x 28.7" x 23.6") P16s, 733mm x 732mm x 605mm (28.8" x 28.8" x 23.8")
Weight	:	P16, 55kg (121.0lb) P16s, 62kg (136.0lb)
Warranty	:	5 years limited (1 year on 'moving parts')

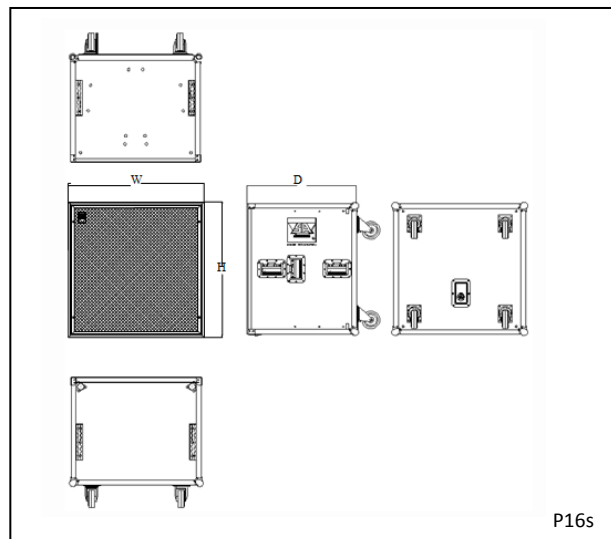
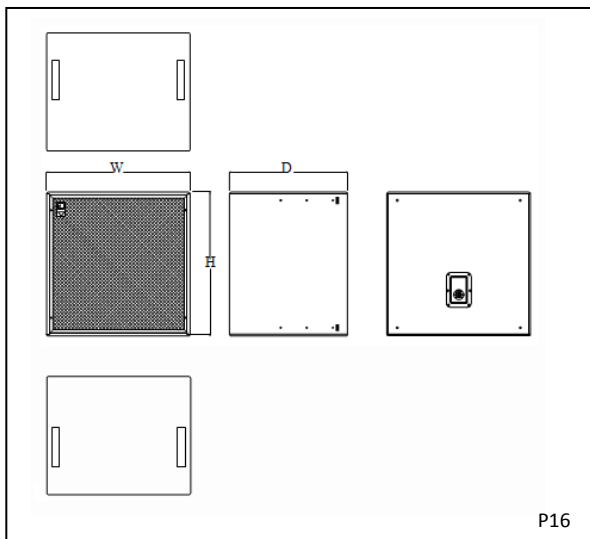

Stage Accompany bv
Haven 28
2984 BR Ridderkerk
The Netherlands
Tel: 31 (0)180 426225
Fax: 31 (0)180 421831
E-mail: info@StageAccompany.com

Copyright 2013 Stage Accompany bv .

The information in this document is continually being developed. Whilst every effort has been made to make it as accurate as possible, no warranty of accuracy is made or implied by the makers. Stage accompany shall have neither liability, nor responsibility to any person or entity with the respect to loss or damages in connection with or arising from the information contained in this document

That's How Music Should Sound!